

ELEV AD 32

**CARACTERISTICAS DE PISTA /  
RWY CHARACTERISTICS**

| RWY | DIRECCION /<br>DIRECTION | THR                               | RESISTENCIA /<br>STRENGTH | TIPO /<br>TYPE       |
|-----|--------------------------|-----------------------------------|---------------------------|----------------------|
| 03  | 026°                     | 24°45'24.76" N<br>107°28'51.58" W | 82/F/A/X/T                | ASFALTO /<br>ASPHALT |
| 21  | 206°                     | 24°46'18.24" N<br>107°28'13.37" W |                           |                      |

**CALLES DE RODAJE, ANCHO, RESISTENCIA /  
TAXIWAYS, WIDTH, STRENGTH**

| TWY | ANCHO /<br>WIDTH | RESISTENCIA /<br>STRENGTH | TIPO /<br>TYPE       |
|-----|------------------|---------------------------|----------------------|
| A   | 23 M             | 60/F/A/X/T                | ASFALTO /<br>ASPHALT |
| A3  | 15 M             | 40/F/C/X/T                |                      |
| B   | 24 M             | 61/F/A/X/T                |                      |
| C   | 18 M             | 61/F/A/X/T                |                      |

CULIACAN  
VOR/DME 112.2  
CUL  
244552N 1072838W



CAMBIOS: DESIGNADOR DE RWY; PCN; PSN; VAR; HS; LEN RWY

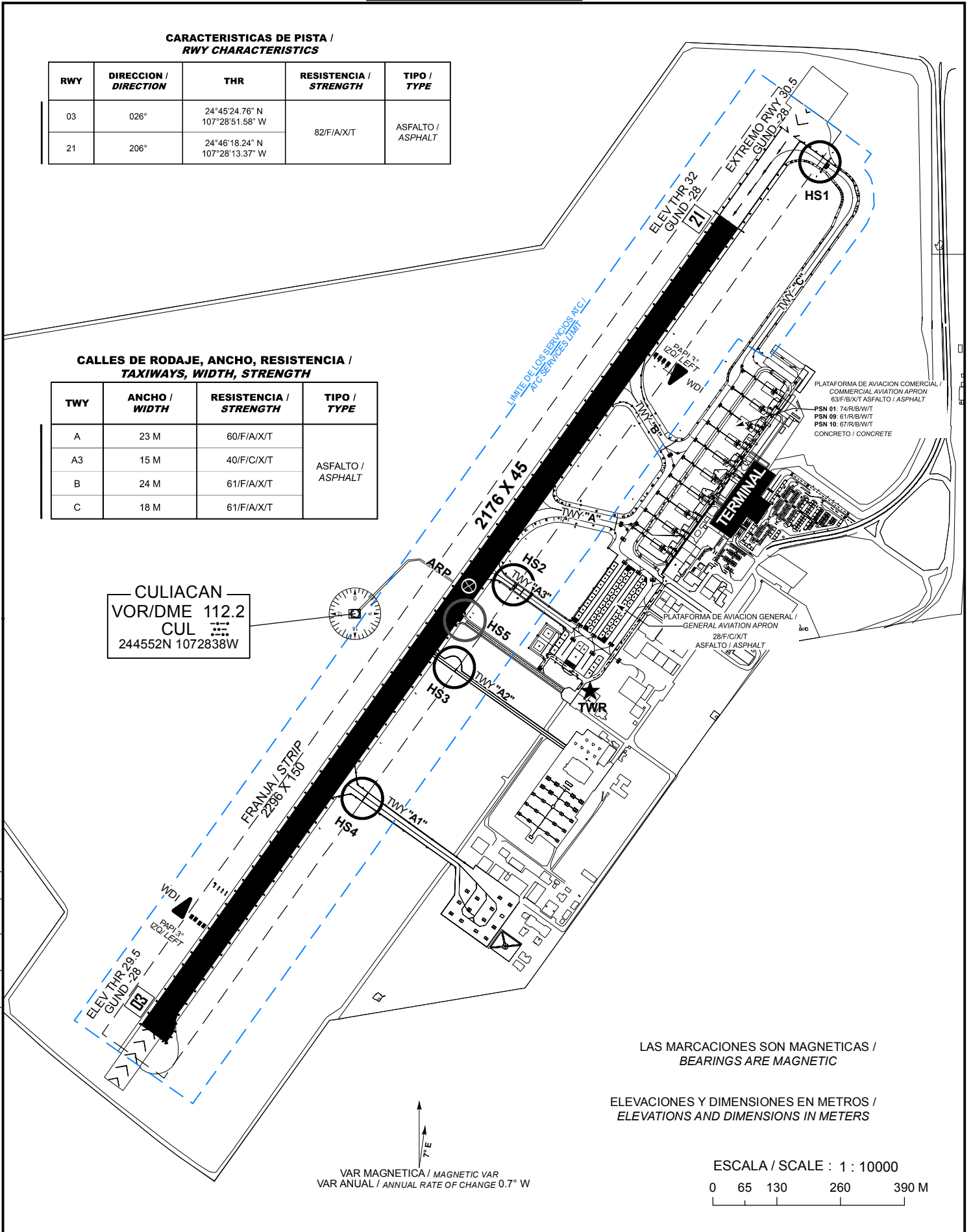

LAS MARCACIONES SON MAGNETICAS /  
BEARINGS ARE MAGNETIC

ELEVACIONES Y DIMENSIONES EN METROS /  
ELEVATIONS AND DIMENSIONS IN METERS

VAR MAGNETICA / MAGNETIC VAR  
VAR ANUAL / ANNUAL RATE OF CHANGE 0.7° W

ESCALA / SCALE : 1 : 10000  
0 65 130 260 390 M



**MINIMOS METEOROLOGICOS / METEOROLOGICAL MINIMUMS  
TECHO EN FT Y VISIBILIDAD EN SM / CEILING IN FT AND VISIBILITY IN SM**

| EQUIPO /<br>AIRCRAFT  | DESPEGUE / TAKE OFF |                   |                             | ALTERNO MINIMOS /<br>ALTERNATE MINIMUMS |
|---|---------------------|-------------------|-----------------------------|---|
|   | DIA / DAY           | NOCHE /<br>NIGHT  | DIA Y NOCHE / DAY AND NIGHT |   |
|   | RWY 02              |                   | RWY 20                      |   |
| 1 Y 2<br>MOTORES  | 500-1<br>(1600M)    | 500-1<br>(1600M)* | 300-1<br>(1600M)            | 1000-2<br>(3200 M)                      |
| 3 O MAS<br>MOTORES  |                     |                   |                             |   |
| * <b>NA</b> SI NO CUMPLE CON UNA RELACION DE ASCENSO DE <b>400 FT/MN</b> /<br>* <b>NA</b> IF THE RATE OF CLIMB OF <b>400 FT/NM</b> IS NOT MET |                     |                   |                             |   |

**NOTAS / REMARKS:**

LUCES EN CALLES DE RODAJE

LIGHTING AIDS ON TWY

PUNTO DE VERIFICACION DEL **VOR THR 02**,  
RADIAL **195°**

CHECKPOINT OF THE **VOR ON THR 02**,  
RADIAL **195°**

TRABAJOS DE DESYERBE (**EVENTUALES**) EN  
FRANJAS DE SEGURIDAD DEL AREA DE  
MOVIMIENTO

**EVENTUAL** TRIMMING WORKS IN SAFETY  
STRIPS OF THE MOVEMENT AREA

**PRECAUCION**, CRUCE DE AVES POR LAS  
TRAYECTORIAS DE LAS PISTAS

**CAUTION:** FLOCKS EVENTUALLY CROSSING  
RUNWAY TRACKS