

PLANO DE ESTACIONAMIENTO Y ATRAQUE DE AERONAVES/
AIRCRAFT PARKING/DOCKING CHART

ELEV AD 1528 M

PDC	132.8	APP	119.3, 120.8, 128.9
TWR	118.1	EMER	121.5
ATIS	127.9	SMC	121.9

GUADALAJARA
AEROPUERTO INTL /
INTL AIRPORT
MIGUEL HIDALGO Y COSTILLA

CALLES DE RODAJE, ANCHO, RESISTENCIA /
TAXIWAYS, WIDTH, STRENGTH

TWY	ANCHO / WIDTH	RESISTENCIA / STRENGTH	TIPO / TYPE
A	23 M	107 F/A/W/T <small>TWY A1 - TWY A2 / TWY A3 - TWY A4</small>	ASFALTO / ASPHALT
		93 R/A/W/T <small>TWY A5 - TWY A6</small>	CONCRETO/ CONCRETE
A7	23 M	69 F/A/W/T	ASFALTO / ASPHALT
C3		96 F/A/W/T	
C4	23 M	54 F/A/W/T	ASFALTO / ASPHALT
E5	40 M	74 R/A/X/T	CONCRETO/ CONCRETE
E6	23 M	69 F/A/W/T	ASFALTO / ASPHALT
E7		64 R/A/W/T	CONCRETO/ CONCRETE
E8	46 M	66 F/A/X/T	ASFALTO / ASPHALT

LAS MARCACIONES SON MAGNETICAS /
BEARINGS ARE MAGNETIC

ELEVACIONES Y DIMENSIONES EN METROS /
ELEVATIONS AND DIMENSIONS IN METERS

**PLATAFORMA AVIACION COMERCIAL/
COMMERCIAL AVIATION APRON**

PSN 1-10 & 23-31: 53 R/A/W/T
PSN 11-17 & 21-22: 74 R/A/W/T
PSN 18-20: 110 R/A/W/T
PSN 32-36 & 41-49: 71 R/A/W/T
PSN 37-40: 74 R/A/W/T
CONCRETO/CONCRETE

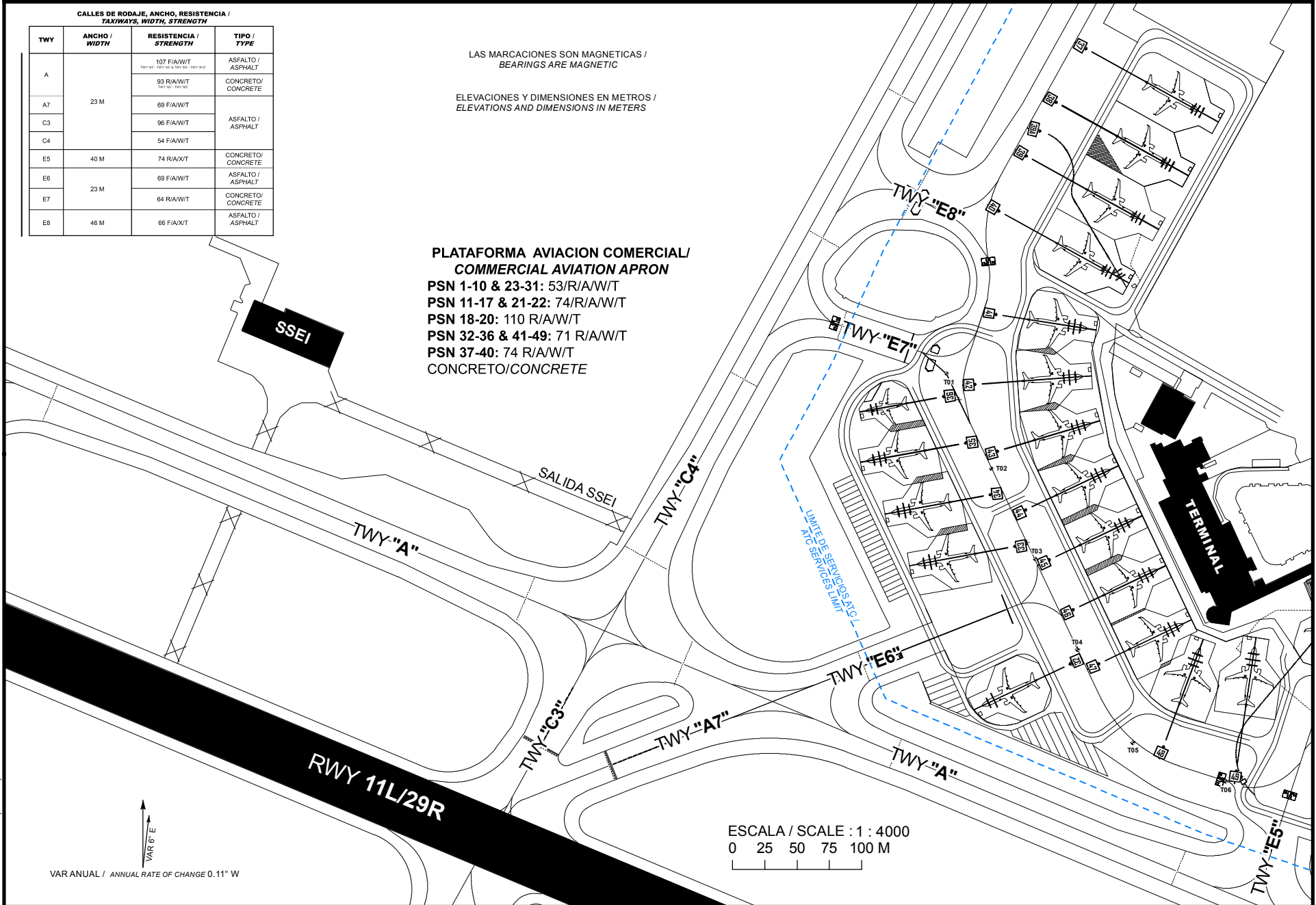

CAMBIOS: PSN, PCN, TWY E8

**COORDENADAS INS, DE PUESTOS DE ESTACIONAMIENTO DE AERONAVES
PLATAFORMA AVIACION COMERCIAL /
COORDINATES INS, FOR AIRCRAFT STANDS
COMMERCIAL AVIATION APRON**

PSN	LAT (N)	LONG (W)	AERONAVE / AIRCRAFT
32	20° 31' 29.21"	103° 18' 22.70"	A321-200
33	20° 31' 32.57"	103° 18' 24.25"	
34	20° 31' 33.81"	103° 18' 24.88"	
35	20° 31' 35.05"	103° 18' 25.47"	
36	20° 31' 36.25"	103° 18' 25.50"	SSJ-100
37	20° 31' 43.15"	103° 18' 16.99"	A321-200
38	20° 31' 41.88"	103° 18' 17.78"	
39	20° 31' 40.62"	103° 18' 18.56"	
39A	20° 31' 39.27"	103° 18' 19.13"	A350-900
40	20° 31' 39.36"	103° 18' 19.34"	A321-200
41	20° 31' 37.99"	103° 18' 20.42"	
42	20° 31' 36.92"	103° 18' 20.33"	
43	20° 31' 35.77"	103° 18' 20.14"	
44	20° 31' 34.63"	103° 18' 19.67"	
45	20° 31' 33.42"	103° 18' 19.10"	
46	20° 31' 32.22"	103° 18' 18.52"	
47	20° 31' 30.92"	103° 18' 17.91"	
48	20° 31' 30.25"	103° 18' 17.40"	
49	20° 31' 30.24"	103° 18' 15.98"	

**COORDENADAS PUNTOS DE TRANSFERENCIAS/
HAND OFF POINTS COORDINATES**

PSN	LAT (N)	LONG (W)
T01	20° 31' 37.07"	103° 18' 23.59"
T02	20° 31' 34.78"	103° 18' 22.50"
T03	20° 31' 32.60"	103° 18' 21.45"
T04	20° 31' 30.44"	103° 18' 20.42"
T05	20° 31' 28.19"	103° 18' 19.08"
T06	20° 31' 27.22"	103° 18' 16.75"
T07	20° 31' 28.16"	103° 18' 12.94"
T08	20° 31' 27.31"	103° 18' 10.30"
T09	20° 31' 26.89"	103° 18' 09.02"
T10	20° 31' 26.32"	103° 18' 06.36"
T11	20° 31' 25.68"	103° 18' 04.38"
T12	20° 31' 24.84"	103° 18' 01.80"
T13	20° 31' 23.89"	103° 17' 58.87"
T14	20° 31' 22.66"	103° 17' 55.69"
T15	20° 31' 21.14"	103° 17' 52.50"
T16	20° 31' 19.47"	103° 17' 49.31"
T17	20° 31' 17.30"	103° 17' 42.63"